

Sideboards

Contemporary Style (finger grooves)



Hampton
65½ w x 36 t x 18 d

Shaker Style (Shaker Inspiration Knobs)



Hampton
66½ w x 36 t x 19 d

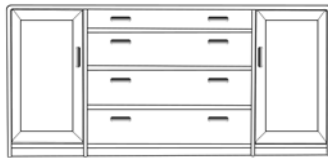

Candi
65½ w x 30¾ t x 18 d



Bradlee
53 w x 36 t x 19 d

Contemporary
Hampton
base only
\$ 3,255
3,425
3,770

Contemporary
Candi
base only
\$ 3,400
3,575
3,935

red oak or birch
¼-sawn white oak, cherry or maple
walnut, mahogany, white oak stained dark

Shaker
Bradlee
base only
\$ 2,625
2,760
3,040

Shaker
Hampton
base only
\$ 2,880
3,030
3,335

Shaker Sideboards with Hutches

Shaker Style
Hampton
with
hutch

\$ 5,105
5,395
5,960

Hutch measurements
(if wall-mounted as shown)
69 w x 31½ t x 15¾ d

Hutch measurements
(if sideboard-mounted as shown)
54½ w x 47½ h x 17¾ d

red oak or birch
¼-sawn white oak, cherry or maple
walnut, mahogany, white oak stained dark

Shaker Style
Bradlee
with
hutch

\$4,650
4,905
5,430

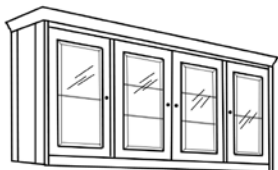

Both methods of mounting the hutch are available for both the Shaker pieces; the method of mounting does not change the price. We install wall-mounted hutches if the customer has chosen for us to deliver the furniture.

Shaker hutches are built with beveled glass-panel doors, glass shelves, crown molding and Shaker Inspiration knobs.

Shaker cabinets include solid tops, pedestals, drawers and shaker-style doors; veneer sides and adjustable wood shelves; silverware holders and Shaker Inspiration knobs.

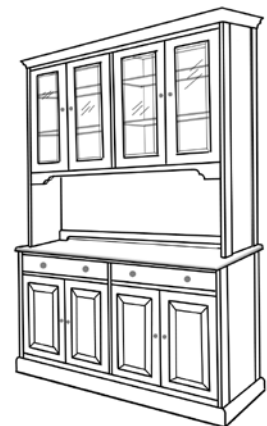

Hutch options: (2) canister lights (Bradlee)--add \$95. (4) canister lights (Hampton) add \$190
Solid tongue and groove plank back--add \$455.

Sideboards

Classic Style



Bradlee Sideboard
53 w x 36 t x 19 d

\$ 3,245 red oak or birch
3,415 ¼-sawn white oak, cherry or maple
3,760 walnut, mahogany, white oak stained dark

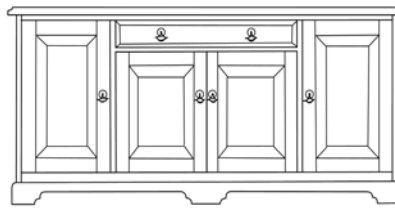

East Hampton Sideboard
66½ w x 36 t x 19 d

\$ 3,425
3,605
3,970

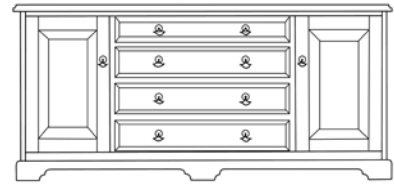

North Hampton Sideboard
66½ w x 31 t x 19 d

\$ 3,615
3,805
4,190

This page covers sideboards and hutches in the Classic style of construction, which includes crown molding, beveled glass and halogen lights in all the hutches, as well as frame & solid raised panel sides, raised drawer faces, cove-rout tops, scalloped pedestals and Classic brass pulls. The Hampton and Bradlee hutches may be either wall-mount or sideboard-mount.

Classic Sideboards with Hutches

Wall-mount
hutch

Sideboard-mount
hutch



A (catalog)
East Hampton
Sideboard & Hutch
66½ w x 80 t x 19 d

A
\$ 6,345
6,690
7,390

East Hampton Hutch includes (6) adjustable glass shelves. Lights are in the center open section.

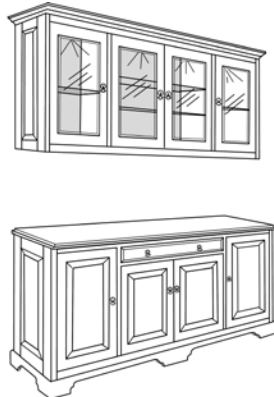

B
Hutch: Hampton
Sideboard: East Hampton
66½ w x variable x 19 d

B
\$ 6,005
6,335
7,000

Indicate "Wall-mount" or "Sideboard-mount" on all Hampton or Bradlee Hutches.

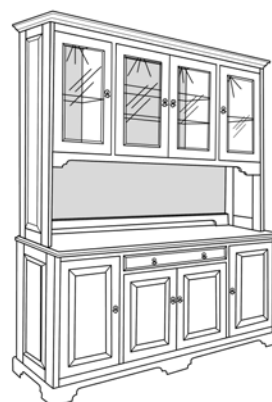

C
Hutch: Hampton
Sideboard: East Hampton
66½ w x 80 t x 19 d

red oak or birch
¼-sawn white oak, cherry or maple
walnut, mahogany, or white oak stained dark

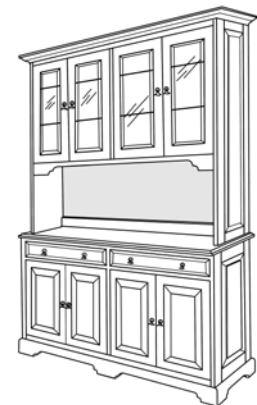

D
Hutch: Bradlee
Sideboard: Bradlee
53 w x 80 t x 19 d

C
\$ 6,005
6,335
7,000

D
\$ 5,615
5,925
6,550

The hutches in B, C & D all have lights in the cabinets, and glass shelves.