

Sideboards

Classic Style



Bradlee Sideboard
53 w x 36 t x 19 d

\$ 3,245 red oak or birch
3,415 ¼-sawn white oak, cherry or maple
3,760 walnut, mahogany, white oak stained dark

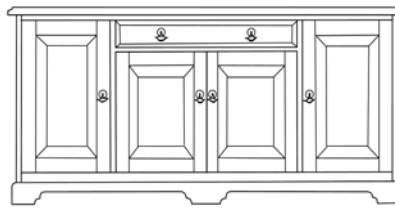

East Hampton Sideboard
66½ w x 36 t x 19 d

\$ 3,425
3,605
3,970

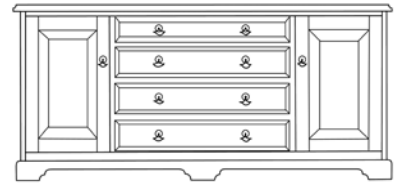

North Hampton Sideboard
66½ w x 31 t x 19 d

\$ 3,615
3,805
4,190

This page covers sideboards and hutches in the Classic style of construction, which includes crown molding, beveled glass and halogen lights in all the hutches, as well as frame & solid raised panel sides, raised drawer faces, cove-rout tops, scalloped pedestals and Classic brass pulls. The Hampton and Bradlee hutches may be either wall-mount or sideboard-mount.

Classic Sideboards with Hutches

Wall-mount
hutch

Sideboard-mount
hutch



A (catalog)
East Hampton
Sideboard & Hutch
66½ w x 80 t x 19 d

A
\$ 6,345
6,690
7,390

East Hampton Hutch includes (6) adjustable glass shelves. Lights are in the center open section.

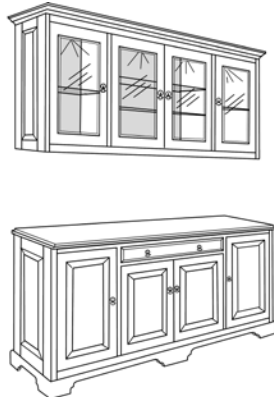

B
Hutch: Hampton
Sideboard: East Hampton
66½ w x variable x 19 d

B
\$ 6,005
6,335
7,000

Indicate "Wall-mount" or "Sideboard-mount" on all Hampton or Bradlee Hutches.

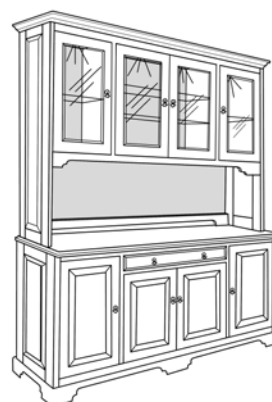

C
Hutch: Hampton
Sideboard: East Hampton
66½ w x 80 t x 19 d

red oak or birch
¼-sawn white oak, cherry or maple
walnut, mahogany, or white oak stained dark

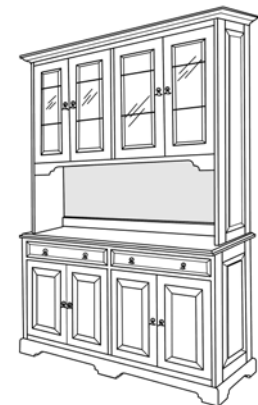

D
Hutch: Bradlee
Sideboard: Bradlee
53 w x 80 t x 19 d

C
\$ 6,005
6,335
7,000

The hutches in B, C & D all have lights in the cabinets, and glass shelves.